



BROWNS

EST: 1830

Agricultural Machinery Co. Ltd

Manufacturers of Farm Implements & Machinery

YARDMASTER

TYRE SCRAPER

Owners Illustrated Instruction Book & Parts List

Grovebury Road, Leighton Buzzard, Bedfordshire. LU7 4UX. UK.

Tel:01525 375157. Fax:01525 385222.

Email:info@brownsagricultural.co.uk

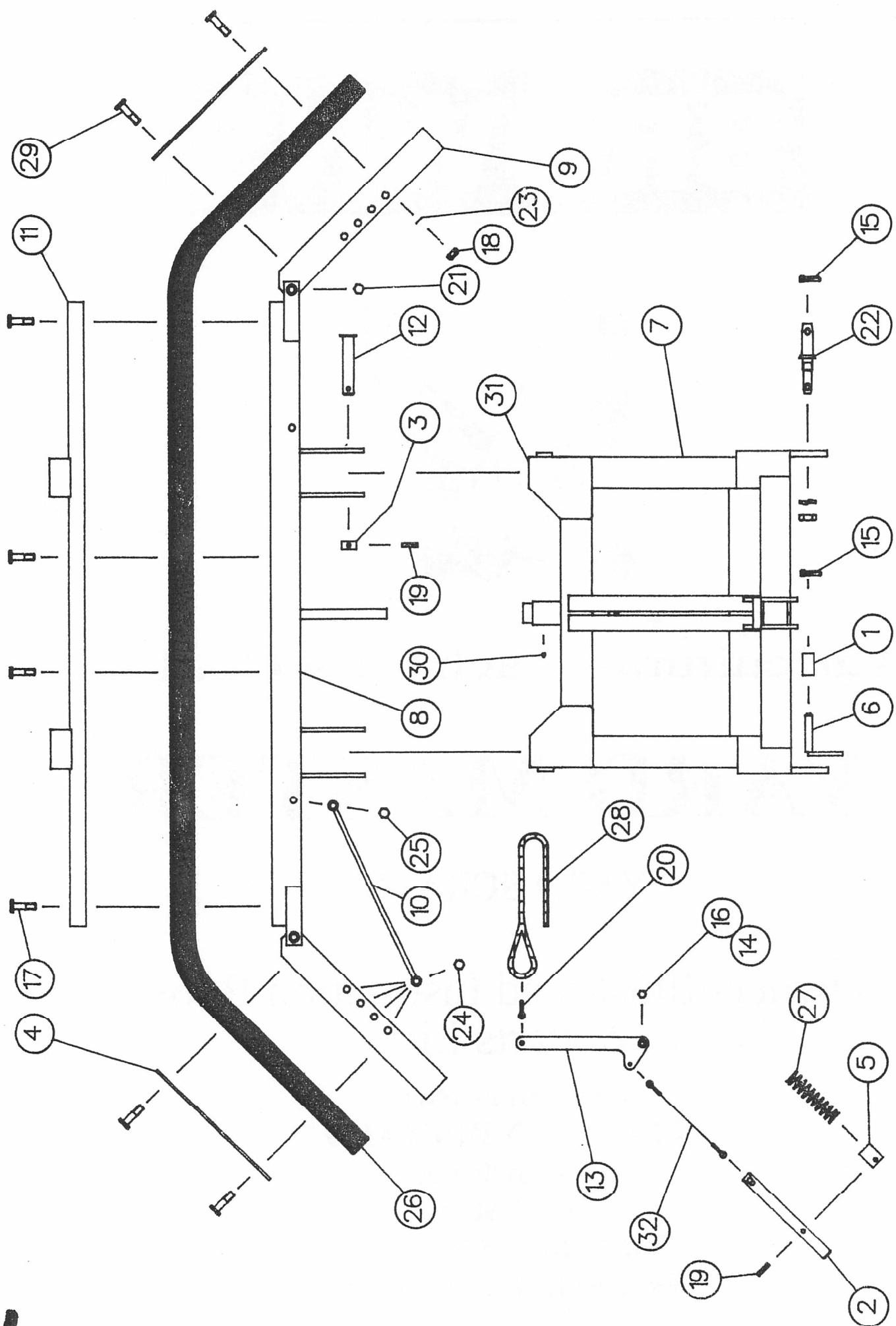

YARDMASTER · YARDSCRAPER

66120 — COMPLETE WITH TYRE RUBBER
66100 — COMPLETE WITH EXTRUDED RUBBER

No	Part No	Description	66120 Tyre	66100 Extruded
1	13784	Sleeve	1	1
2	14051	Pin, Catch	1	1
3	14052	Pin, Collar	2	2
4	16231	Wing Plate (66120 only)	2	*
4	14997	Wing Plate (66100 only)	*	2
5	14078	Spring Pin Collar	1	1
6	71856	Pin, Category 1 Top	1	1
7	52587	Main Frame	1	1
8	52716	Main Channel	1	1
9	52717	Side Channel	2	2
10	52797	Side Channel Support	2	2
11	52718	Rear Channel (66120 only)	1	*
11	52344	Rear Channel (66100 only)	*	1
12	51991	Pin, Pivot	2	2
13	52331	Lever	1	1
14	70012	M12 Locknut	1	1
15	70033	Linch Pin	3	3
16	70050	Bolt M12 x 110 LG	1	1
17	70327	Bolt M16 x 90 LG (66120 only)	4	*
17	70331	Bolt M16 x 75 LG (66100 only)	*	8
18	70342	M16 Locknut	14	14
19	70461	Tension Roll Pin	3	3
20	70478	Chain Shackle	1	1
21	70607	Bolt M16 x 260 LG	2	2
22	70660	Lower Linkage Pin	2	2
23	70726	Washer M16	4	4
24	70988	Bolt M16 x 220 LG	2	2
25	71028	Bolt M16 x 170 LG	2	2
26	71029	Rubber (Tyre Type)	1	*
26	71360	Rubber (Extruded Type)	*	1
27	71030	Spring	1	1
28	71031	Pull Rope	1	1
29	71054	Cup Square Bolt M16 x 90 LG (66120 only)	4	*
30	71055	Grease Nipple (Drive Fit)	1	1
31	71324	Plastic Blanking Cap	2	2
32	71487	Lever Wire	1	1

OPERATOR'S INSTRUCTIONS

- (1) Attach the Yardmaster to the tractor via the three point linkage. Category 1 and 2 are provided.
- (2) Ensure that the front of the main frame is vertical, adjust top link as necessary.
- (3) Adjust the tractor rear linkage arms so that the rubber is parallel to the ground.
- (4) Operate with the tractor hydraulics in the float position.
- (5) To adjust the working width remove bolts (Item 25 - see diagram), loosen side wing bolts (Item 17). Move side wings to the desired position, tighten and replace the bolts. The rings on the side wings may be used to assist this operation.
- (6) To reverse the scraper, pull the rope to release the pin. (This is best done with the machine on the ground). Raise the three point linkage and the blade will hang vertically from the frame, lowering the linkage whilst driving in the desired direction will automatically lock the blade in the new position.
- (7) When working be alert for obstructions.
- (8) Do not use on non concrete areas, where projections could damage the rubber.
- (9) The Yardmaster will be most effective when the manure has a high liquid content.



EC DECLARATION OF CONFORMITY

Manufacturer : Browns Agricultural Machinery Co. Ltd.

Description of Machinery : YARDMASTER Muck Scraper (Tyre)

Model Number : 66120

This machine complies with EC Directives, Transposed Harmonised Standards, National Standards and Technical Specifications as follows:

89/392/EEC 91/386/EEC 93/44/EEC 93/68/EEC EN 292 pr EN 691

The machinery has been designed taking into account the essential Health & Safety Standards as detailed in the Supply of Machinery (Safety Regulations) 1992.

For and on behalf of the Manufacturer

Name : J. W. G. BROWN

Status : MANAGING DIRECTOR

The above machinery taking into account the state of art, complies with or is designed and constructed so far as possible, to comply with the relevant Health & Safety requirements as indicated in the Technical file.

THE COMPANY IS CONTINUALLY STRIVING TO IMPROVE ITS PRODUCTS AND RESERVES THE RIGHT TO MAKE IMPROVEMENTS OR CHANGES WITHOUT INCURRING ANY OBLIGATION TO ALTER ANY OF ITS MACHINES PREVIOUSLY SOLD.