



BROWNS

EST: 1830

Agricultural Machinery Co. Ltd

Manufacturers of Farm Implements & Machinery

SLIT MASTER

PASTURE AERATOR

Owners Illustrated Instruction Book & Parts List

Grovebury Road, Leighton Buzzard, Bedfordshire. LU7 4UX. UK.

Tel:01525 375157. Fax:01525 385222.

Email:info@brownsagricultural.co.uk

OPERATORS INSTRUCTIONS

Brown's 'SLITMASTER' comes complete with four legs; these are to protect the blades when parking other than on grass. The 'SLITMASTER' is **not** supplied with concrete block ballast weights; these are obtainable from most Builders Merchants.

	65700	65710	65720
Specifications:	1.5m Wide	2.3m wide	3.0m wide
Overall Width	1651mm (5'6")	2300mm (7'7")	3000mm (9'10")
Overall Depth	760mm (2'6")	760mm (2'6")	760mm (2'6")
Overall Height	1200mm (3'11")	1200mm (3'11")	1200mm (3'11")
Machine Weight	210Kgs (463lbs)	310Kgs (688lbs)	407Kgs (898lbs)
Ballast Weight	500Kgs (1102lbs)	760Kgs (1653lbs)	1000Kgs (2204lbs)
Number of Blades	24	36	48

- [1] Attach the 'SLITMASTER' to the tractor via the 3 point linkage.
- [2] Ensure the 'SLITMASTER' is level with the ground by adjusting the top link.
- [3] Lift up the 'SLITMASTER' on tractor hydraulics and remove the legs, replacing them upside down in the box section frame.
- [4] Add the Ballast blocks in the weight frame until required depth is reached. Up to 56 blocks can be used on the 3.0m machine and 40 on the 2.3m machine. The maximum slit depth is 205mm (8")
- [5] It is advisable not to go any faster than 8 to 10 m.p.h. This will depend on ground conditions.
- [6] Do not go over concrete or brick manholes. Always look out for large stones and other obstructions.
- [7] If you require a wider slit, this can be done by adjusting the angle of the rotors, by moving the outer bearings to the forward set of holes.

NOTE: The self-aligning bearings require greasing once a week. Check the tightness of all nuts and bolts regularly.

65700 - SLITMASTER (1.5M)

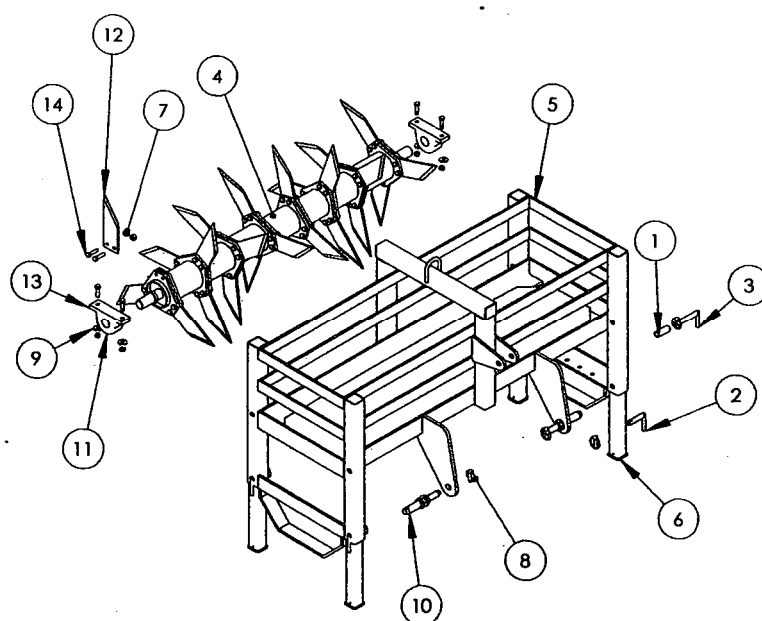

ITEM	PART NO	DESCRIPTION	NO OFF
1	13784	Sleeve	1
2	51673	Pin (SA71)	4
3	51684	Top Linkage Pin (Cat 1)	1
4	52294	Rotor	1
5	53061	Main Frame	1
6	52346	Stand	4
7	70012	Nut (Thin Type)	52
8	70033	Linch Pin $7/16$ R	7
9	70136	Washer (12 id x 28 od)	4
10	70660	Lower Linkage Pin	2
11	70820	$\frac{1}{4}$ BSF 90° Grease Nipple	2
12	71328	Blade	24
13	71331	Slitmaster Bearing	2
14	71737	Bolt M12 x 45	52

65710 – 2.3M SLITMASTER

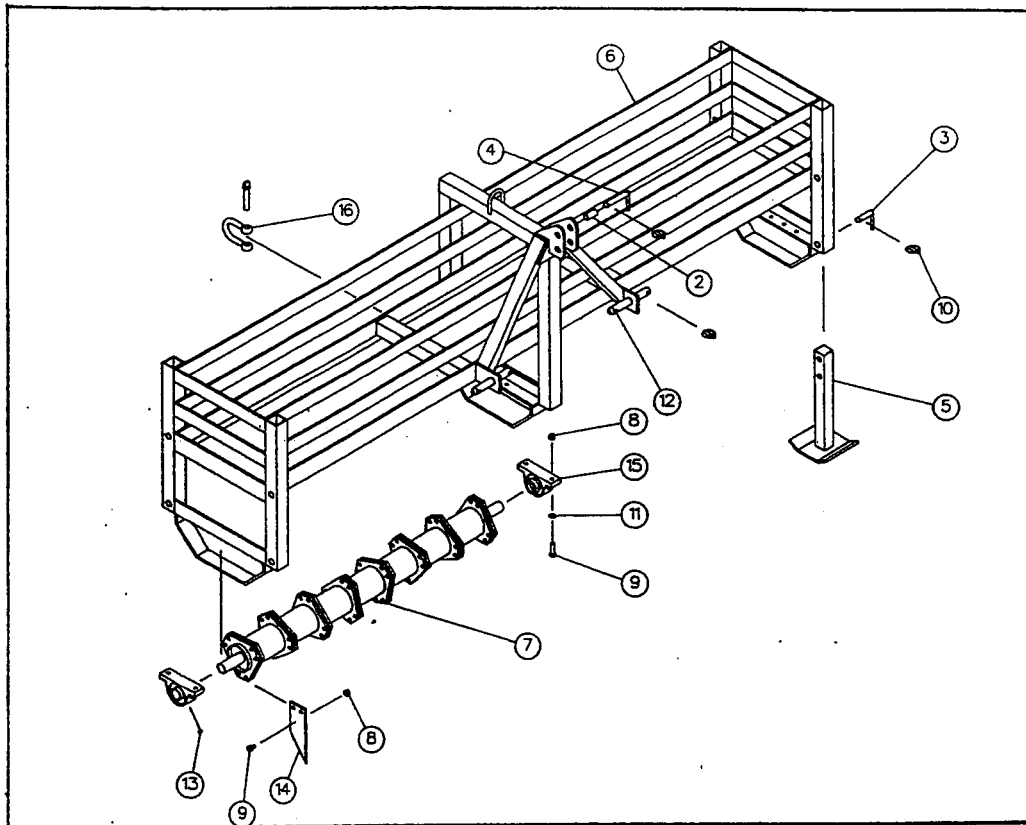

ITEM	PART NO	DESCRIPTION	NO OFF
2	13784	Sleeve	1
3	51673	Pin (SA71)	4
4	51684	Top Linkage Pin (Cat 1)	1
5	51918	Leg Weld Assembly	4
6	52299	Main Frame	1
7	52300	Rotor	2
8	70012	Nut (Thin Type)	80
9	70026	Setscrew	80
10	70033	Linch Pin 7/16 R	7
11	70136	Washer (12 id x 28 od)	8
12	70660	Lower Linkage Pin	2
13	70820	¼ BSF 90° Grease Nipple	4
14	71328	Blade	36
15	71331	Slitmaster Bearing	4
16	71332	Slitmaster Shackle	1

65720 – 3.0M SLITMASTER

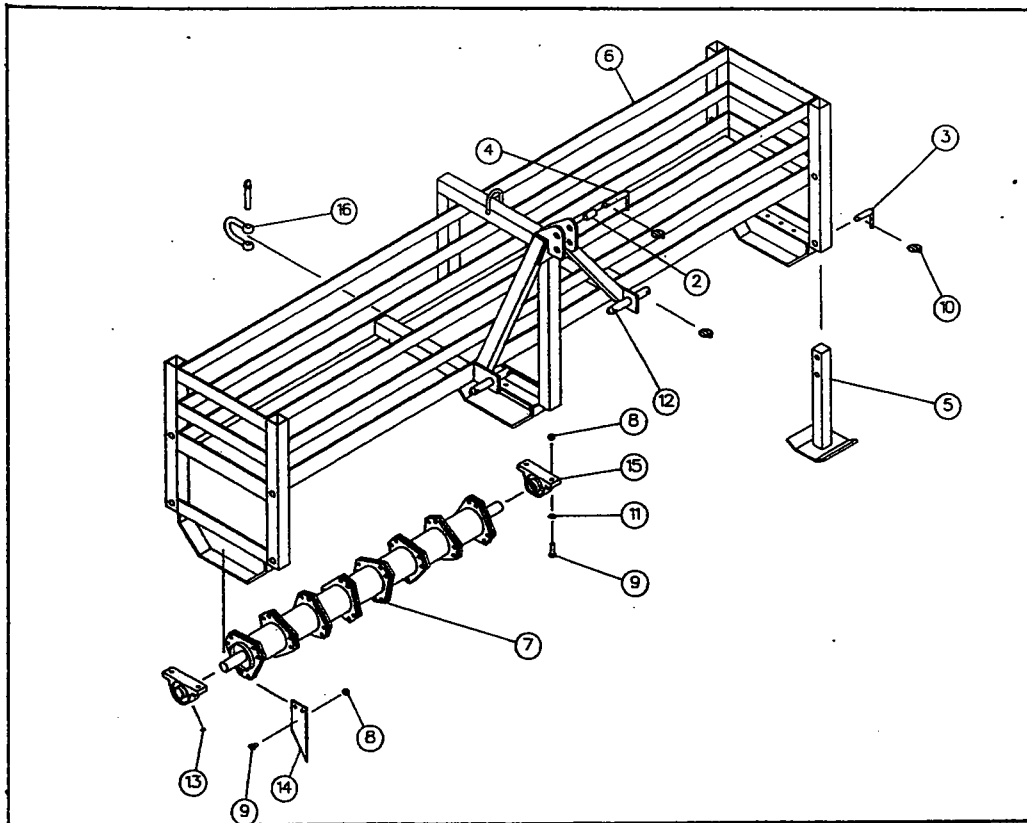

ITEM	PART NO	DESCRIPTION	NO OFF
2	13784	Sleeve	1
3	51673	Pin (SA71)	4
4	51684	Top Linkage Pin (Cat 1)	1
5	51918	Leg Weld Assembly	4
6	52293	Main Frame	1
7	52294	Rotor	2
8	70012	Nut (Thin Type)	104
9	70026	Setscrew	104
10	70033	Linch Pin $7/16$ R	7
11	70136	Washer (12 id x 28 od)	8
12	70660	Lower Linkage Pin	2
13	70820	$\frac{1}{4}$ BSF 90° Grease Nipple	4
14	71328	Blade	48
15	71331	Slitmaster Bearing	4
16	71332	Slitmaster Shackle	1

ROLLER KITS

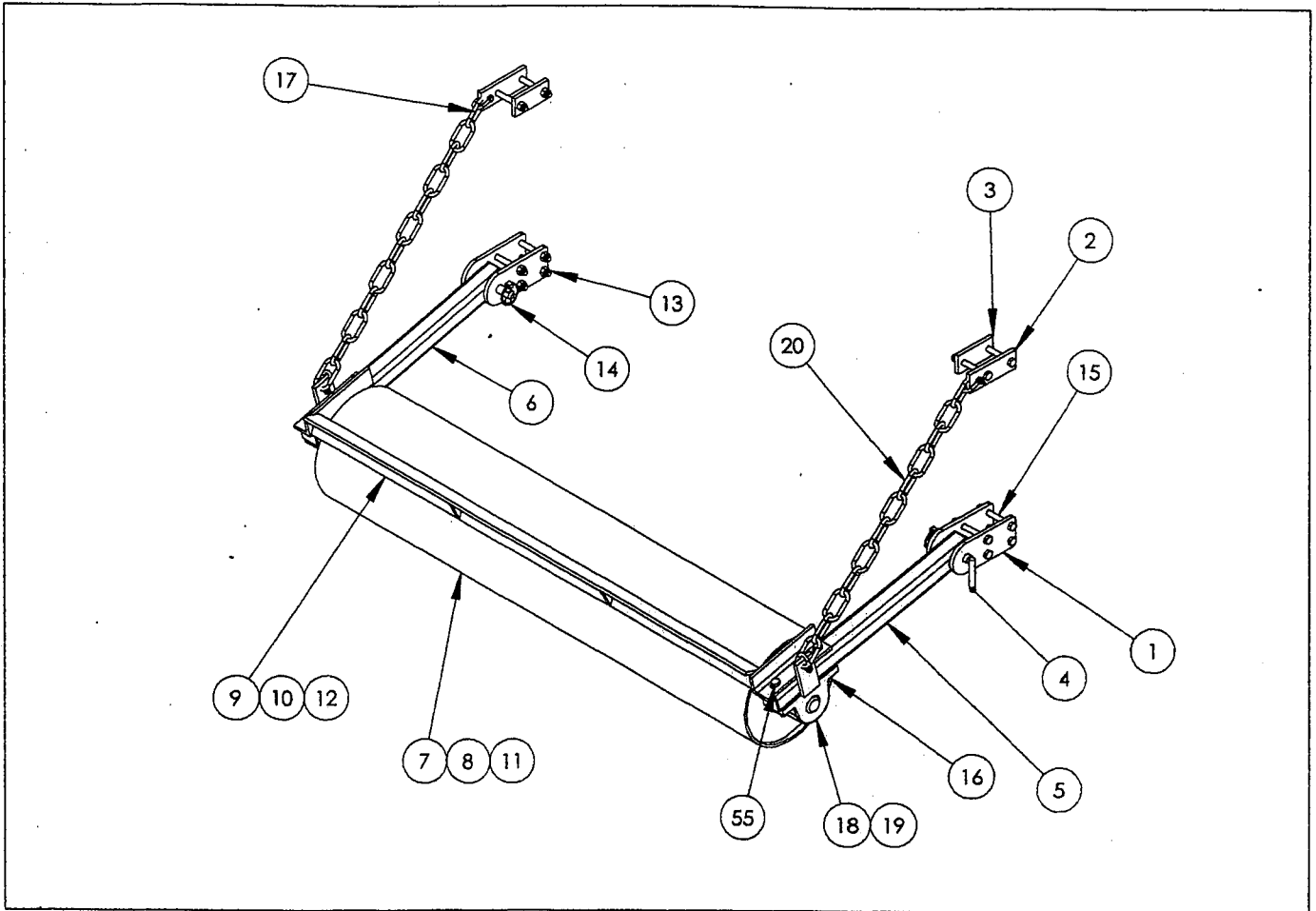

53147 **Roller for 1.5m Model**

52440 **Roller for 2.3m Model**

52442 **Roller for 3.0m Model**

ROLLER KITS

ITEM	PART NO	DESCRIPTION	NO OFF
1	15361	Roller Bracket	4
2	15362	Roller Bracket	2
3	15363	Roller Bracket	2
4	51684	Top Link Pin	2
5	52457	Swing Arm Right Hand	1
6	52458	Swing Arm Left Hand	1
7	52469	Roller 2.3m Model	1
8	52470	Roller 3.0m Model	1
9	52606	Scraper 2.3m Model	1
10	52607	Scraper 3.0m Model	1
11	53148	Roller 1.5m Model	1
12	53149	Scraper 1.5m Model	1
13	70012	M12 Nylock Nut	16
14	70033	Linch Pin 7/16 R	2
15	70065	Bolt M12 x 100	16
16	70136	Washer (12 id x 28 od)	4
17	70478	Chain Shackle	4
18	70820	Grease Nipple	2
19	71331	Slitmaster Bearing	2
20	71424	Chain	2



EC DECLARATION OF CONFORMITY

Manufacturer : Browns Agricultural Machinery Co. Ltd.

Description of Machinery : Slitmaster 3.0m Grassland Aerator

Model Number : 65720

This machine complies with EC Directives, Transposed Harmonised Standards, National Standards and Technical Specifications as follows:

89/392/EEC 91/386/EEC 93/44/EEC 93/68/EEC EN 292 pr EN 691

The machinery has been designed taking into account the essential Health & Safety Standards as detailed in the Supply of Machinery (Safety Regulations) 1992.

For and on behalf of the Manufacturer

Name : J. W. G. BROWN

Status : MANAGING DIRECTOR

The above machinery taking into account the state of art, complies with or is designed and constructed so far as possible, to comply with the relevant Health & Safety requirements as indicated in the Technical file.

THE COMPANY IS CONTINUALLY STRIVING TO IMPROVE ITS PRODUCTS AND RESERVES THE RIGHT TO MAKE IMPROVEMENTS OR CHANGES WITHOUT INCURRING ANY OBLIGATION TO ALTER ANY OF ITS MACHINES PREVIOUSLY SOLD.