



EAGLE

FOR 8 CONVENTIONAL OR 2 BIG BALES

Owners Illustrated Instruction Book & Parts List

Grovebury Road, Leighton Buzzard, Bedfordshire. LU7 4UX. UK.
Tel:01525 375157. Fax:01525 385222.
Email:info@brownsagricultural.co.uk

INTRODUCTION

The Eagle bale grab is a heavy duty grab purpose built to withstand modern telescopic material handlers as well as conventional tractor mounted loaders. Compared to the standard flat eight grabs the Eagle is more heavy duty with longer and stronger claws. This enables the grab to handle conventional bales both length ways or side ways in packs of eight, as well as the larger high density bales in groups of two. It should be noted that in order to handle flat eights and stack them closely it means larger high density bales measuring 2.4m in length will overhang the front of the grab. The bale guide provided can be adjusted to any width to cope with the specific bales being moved and can be mounted on either side of the grab to suit the operator.

CLAW RAM BREAKDOWN

11	91823	End Cap	1
12	91824	Piston Head	1
13	91829	Head Bush	1
14	91830	Seal Kit	1
15	91835	Ram Rod	1

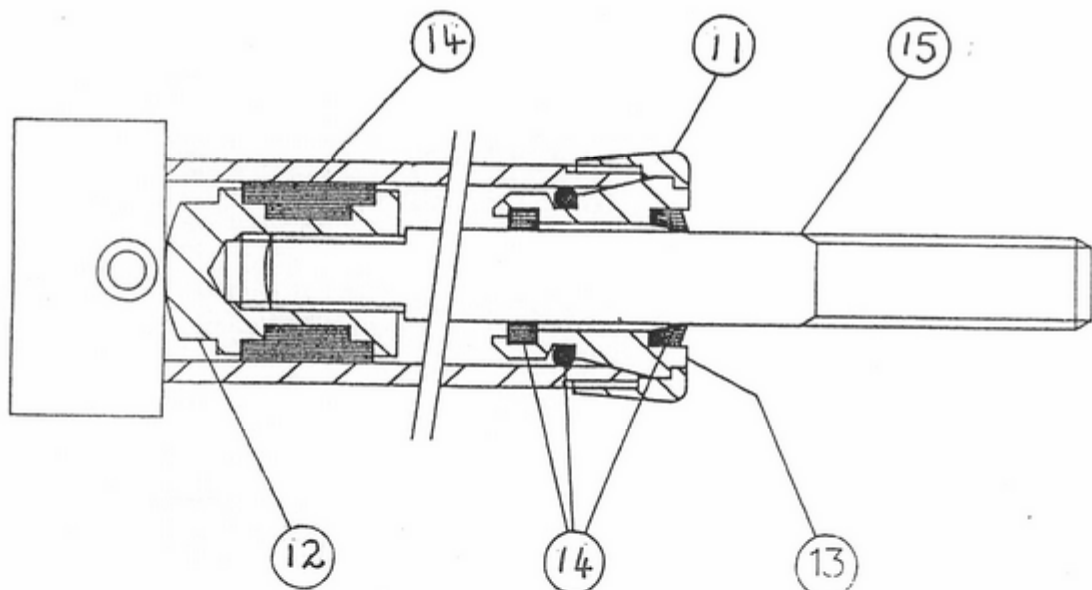

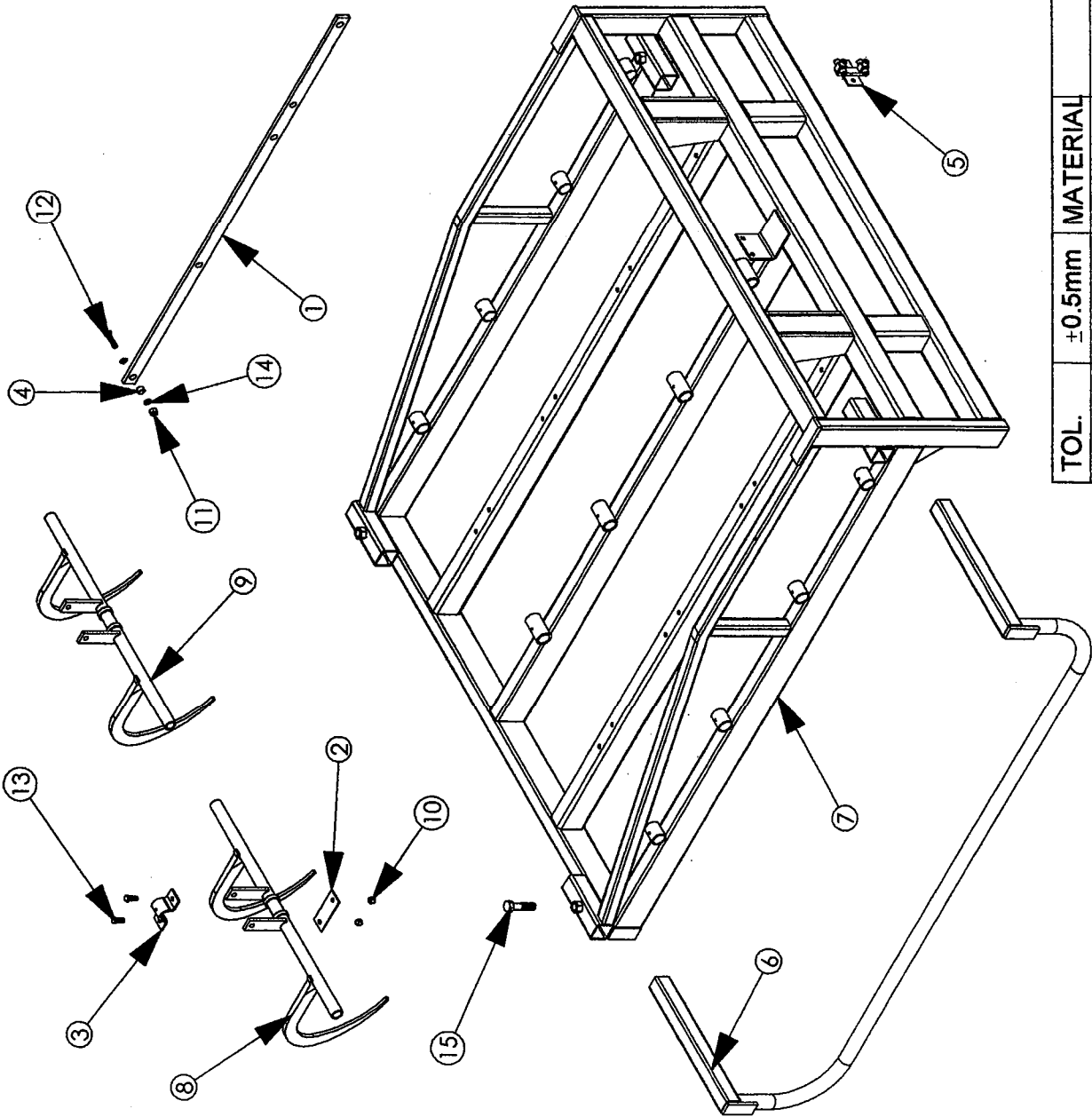

No.	Part No.	Description	Qty
1	13094	CENTRE BAR	4
2	13440	CENTRE SUPPORT	8
3	13441	CENTRE BEARING	8
4	13918	BUSH	16
5	50925	T.PIECE	1
6	52687	BALE GUIDE	1
7	53427	MAIN FRAME	1
8	53431	CLAW UNIT LH	4
9	53432	CLAW UNIT RH	4
10	70011	M10 NYLOCK NUT	18
11	70012	M12 NYLOCK NUT	16
12	70026	M12x45 SETSCREW	16
13	70058	M10x30 SETSCREW	18
14	70136	M12 WASHER	36
15	71407	M20x50 BOLT	2

Parts List		EAGLE MK2		Part No. 65221	
TOL.	±0.5mm	MATERIAL	TITLE	Browns Agricultural Machinery Company Limited Mentmore Road - Leighton Buzzard Beds. LU7 7NX. Tel:- (01525) 375157	
SCALE	1:18	ISSUE	1		
DATE	3/2/2007	DATE	3/2/2007		
DRAWN	D.Hanson	DRAWN	D.Hanson		



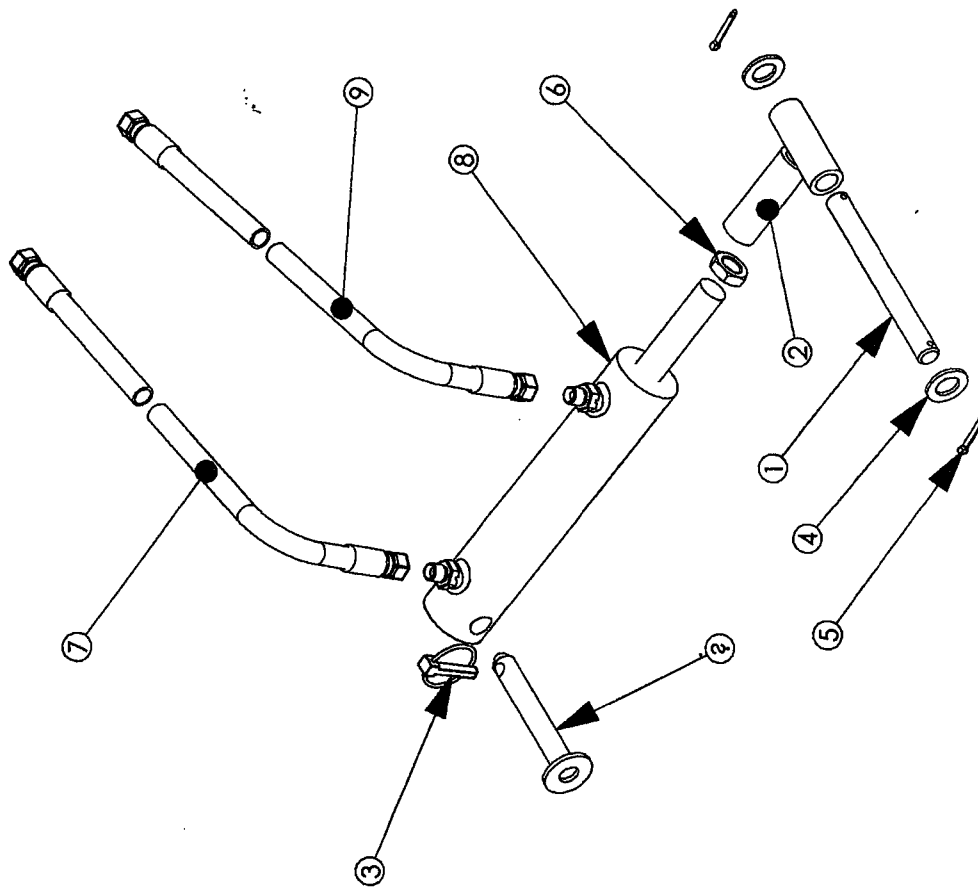

No.	Part No.	Description	Qty
1	15365	PIN	2
2	52546	RAM T PIECE	2
3	70033	LINCH PIN	2
4	70073	M20 WASHER	4
5	70133	COTTER PIN	4
6	70138	HALF NUT 7/8 UNF	2
7	71033	HOSE 0.5m	2
8	71460	RAM	2
9	71896	HOSE 0.7m	2

Parts List

RAM ASSEMBLY

Part No.

Browns Agricultural Machinery Company Limited
Mentmore Road - Linslade - Leighton Buzzard
Beds. LU7 7NX. Tel:- (01525) 375157



TOL.	±0.5mm	MATERIAL	TITLE
SCALE	1:2		
ISSUE	1		
DATE	3/2/2007		
DRAWN	D.Hanson		

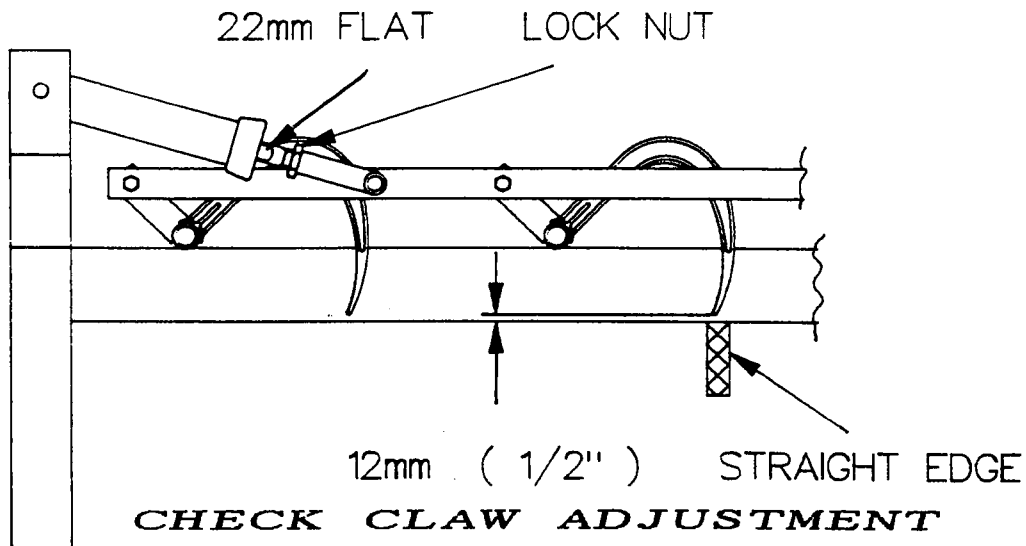

- 1 Fully retract Claw Ram.
- 2 Place a straight edge under frame as shown and check clearance.
- 3 To adjust clearance, release Lock Nut, turn Ram Rod by flats shown in the appropriate direction to give measurement shown, tighten Lock Nut.

*******NOTE*******

ON NO ACCOUNT MUST THE CLAWS PROJECT BELOW THE FRAME WHEN THE CLAW RAM IS FULLY RETRACTED OR CLAW DAMAGE MAY RESULT.

WARNINGS

- 1 Allow only qualified persons to operate the Loader.
- 2 Never allow anyone on the Loader and/or the attachments when in operation.
- 3 Operate the tractor at reduced speed, especially when making a turn.
- 4 Always allow for added length of Loader when making turns.
- 5 In transit keep Loader in lowest position possible.
- 6 Exercise extreme caution on inclines, irregular or uneven ground.
- 7 Avoid lowering a heavy load and stopping suddenly.
- 8 Do not walk or work under raised load or attachment.
- 9 Never leave loader or attachment in raised position unattended.
- 10 Ensure that the Claw Ram is fully retracted after each operation to eliminate damage to claws.
- 11 Check tightness of all bolts periodically. Oil all moving parts regularly.
- 12 Do not leave Ram extended when not in use as this can cause damage to the rods.
- 13 Do not use the Buzzard frame as a crane jib.
- 14 **Note** - Extra supports not supplied by Browns may be required when welding Quick Detach Brackets to the Buzzard Rear Frame. Also make sure both box sections are tied together using heavy plate.



EC DECLARATION OF CONFORMITY

Manufacturer : Browns Agricultural Machinery Co. Ltd.

Description of Machinery : Eagle Heavy Duty Grab

Model Number : 65221

This machine complies with EC Directives, Transposed Harmonised Standards, National Standards and Technical Specifications as follows:

89/392/EEC 91/386/EEC 93/44/EEC 93/68/EEC EN 292 pr EN 691

The machinery has been designed taking into account the essential Health & Safety Standards as detailed in the Supply of Machinery (Safety Regulations) 1992.

For and on behalf of the Manufacturer

Name : J. W. G. BROWN

Status : MANAGING DIRECTOR

The above machinery taking into account the state of art, complies with or is designed and constructed so far as possible, to comply with the relevant Health & Safety requirements as indicated in the Technical file.

THE COMPANY IS CONTINUALLY STRIVING TO IMPROVE ITS PRODUCTS AND RESERVES THE RIGHT TO MAKE IMPROVEMENTS OR CHANGES WITHOUT INCURRING ANY OBLIGATION TO ALTER ANY OF ITS MACHINES PREVIOUSLY SOLD.